

Installation Instructions

Panel Track



Thank You

Thank you for choosing Genesis Custom Window Shades. With proper installation and care, your new shades will provide many years of beauty and performance.

Before Installing

Remove shade from the package. Keep all packaging until shade operates to your satisfaction. Contents of your hardware package may vary depending on options chosen. Additional fasteners may be needed on your specific mounting surface.

Tools

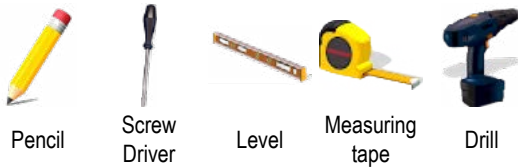

Fasteners

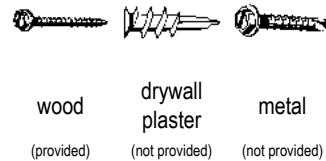

All bracket mounting screws must screw into wood. If the installation requires mounting the brackets to a surface other than wood, be sure to use the appropriate fastener

Your Track

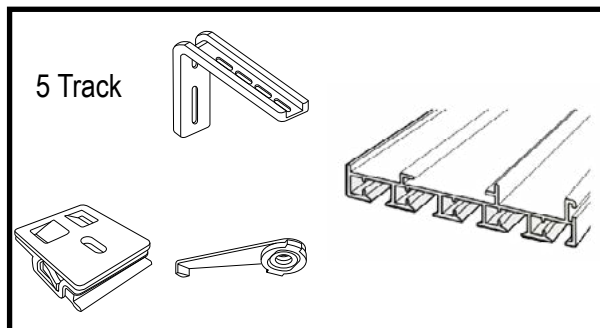
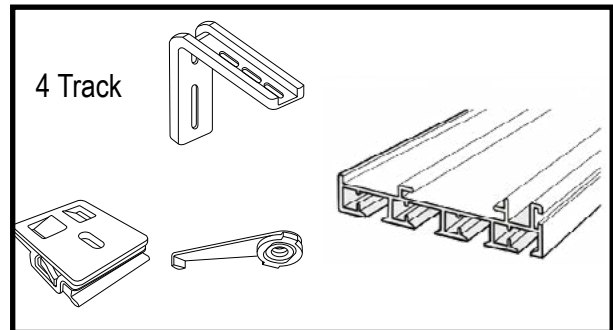
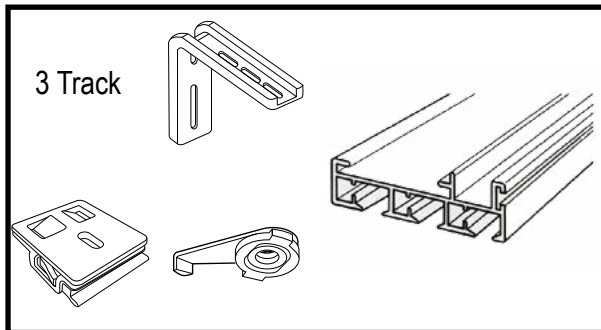

Installation Instructions

Step 1 Space Brackets in Window

Shade Width	Brackets Required
Up to - 52 1/4"	2
52 5/16" - 72 1/4"	3
72 5/16" - 104 1/4"	4
104 5/16" - 130 1/4"	5
130 5/16" - 144 1/4"	6
144 5/16" - 182 1/4"	7
182 5/16" - 192"	8

Center track in opening. Measure 4" in from each end of the headrail and mark the bracket location on the mounting surface. Space additional brackets evenly between the end brackets.

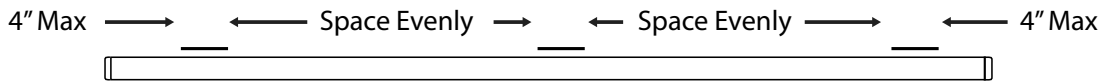

A minimum clearance between the center of the hole in bracket and the window is required to ensure enough room to accommodate the brackets

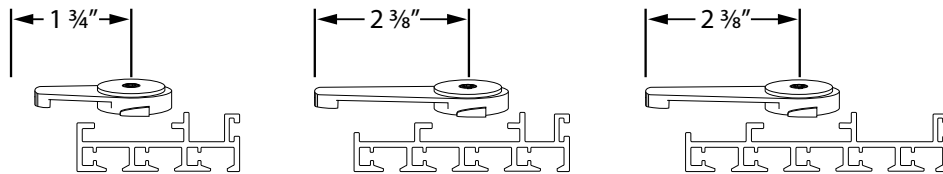

Step 2 Install Brackets

Make sure that the Brackets are level and in a straight line

Inside Mount

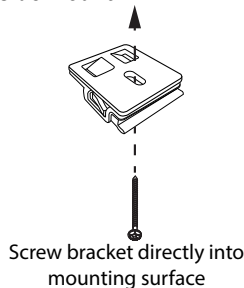

Outside Mount

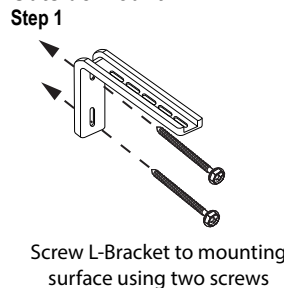

Step 2

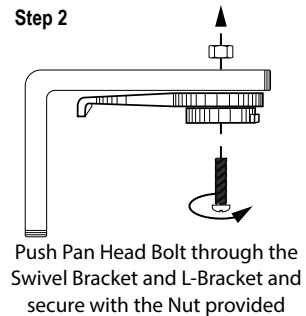

Step 3 Install Track

Outside Mount

Step 1

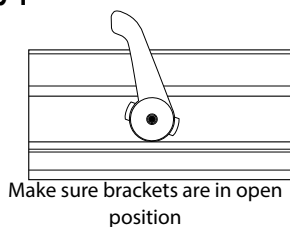

Step 2

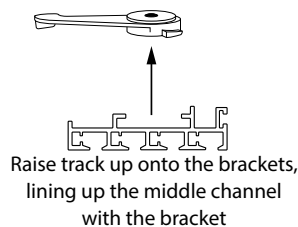

Step 3

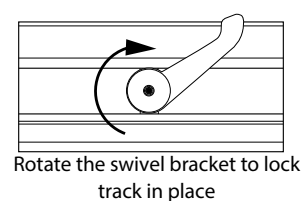

4 channel track shown
End caps and sliders removed for clarity

Starting with any brackets in the center and working outwards eases installation for one person

Installation Instructions

Inside Mount

Step 1

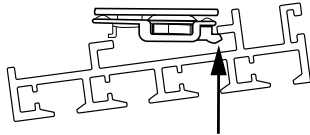

Tilt track down in the back and insert Spring Loaded Tab on the bracket into the channel on the Track

Step 2

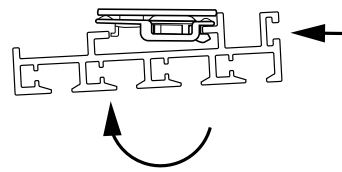

Push track forward into Spring Loaded Bracket until the rear channel of the Track clears the retainer clip on the Bracket

4 channel track shown
End caps and sliders removed for clarity

Step 3

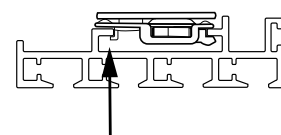

Raise the back end of the track and ensure that your track is fully seated into the bracket's clips

Step 4 Install Panels

Step 1

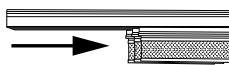

Slide all Panel Carriers to one side to ease installation

Step 2

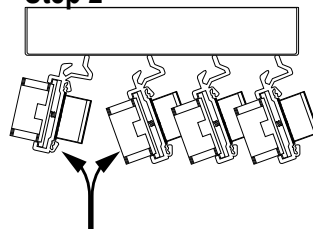

Separate the Carriers by pushing back on one and forwards on the rest to clear the Carrier's catches

Step 3

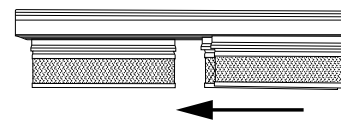

With the Panel Carrier isolated begin to install panels

Step 4

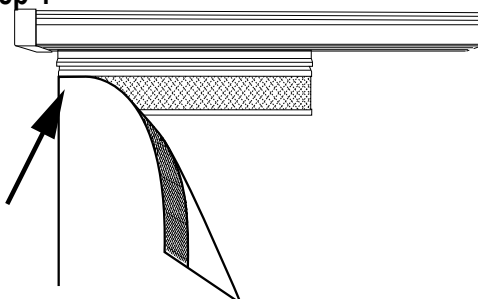

Start with one corner of the panel and line up with the Carrier's corner

Step 5

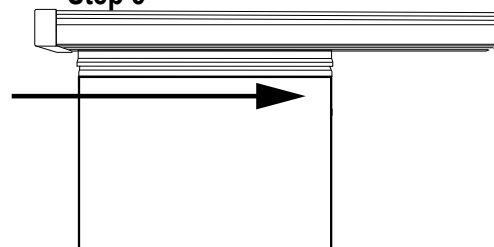

Press down on the Panel all the way across and ensure it lines up level with the Carrier

Repeat steps for each panel and then reverse steps to return Carriers to original position for proper operation

Step 5 Install Cord Tensioner, Artisan Valance

Cord Tension Lock

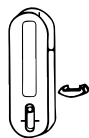

See Cord Tension Lock installation instructions

Artisan Valance

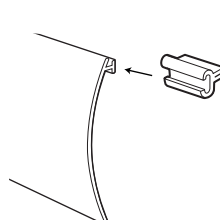

Slide the Valance Clips onto the ends of the Artisan Valance

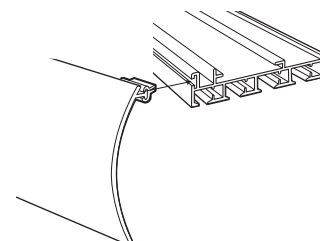

Snap the Artisan Valance Clips into the front of the Track