

Bead Chain/Cord Tension Lock & P-clip Installation Instructions

Always keep the bead chain and cord loops secure and out of reach of children and pets.

Step 1 Attach the Bracket to Cord Tension Lock

Outside Mount

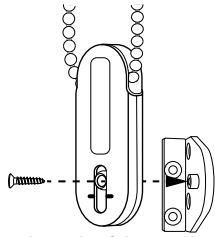

Insert the nub of the Bracket into the Cord Tension Lock and secure with small screw provided

Inside Mount

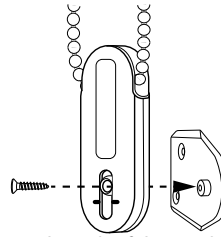

Insert the nub of the Bracket into the Cord Tension Lock and secure with small screw provided

Step 2 Mark Mounting Position

Step 1

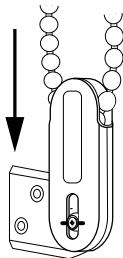

With the Shade securely installed pull the chain taut in the window opening with the bracket against the mounting surface

If the Tension Lock locks onto the loop, it is too loose and the bracket and lock should be moved down

Step 2

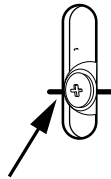

Make sure the bracket's screw hole is aligned with the horizontal mark on the Tension Lock

Step 3

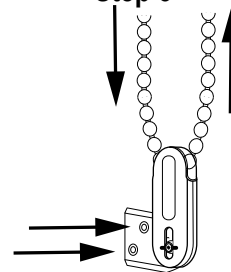

While holding the lock firmly in place, check if the loop can move freely through it and then mark holes

If the loop does not run freely through the lock, it is too tight and the bracket and lock should be moved up

Step 3 Attach the Bracket to Mounting Surface

Attach to mounting surface using the two longer screws provided

Outside Mount

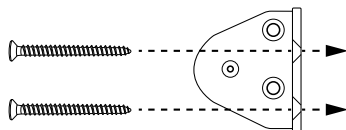

The Bracket will need to be removed from the Tension Lock to install

Inside Mount

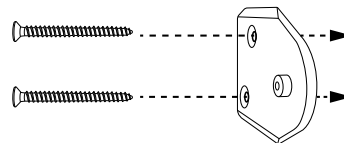

Cord Tension Lock removed for clarity

Re-attach the Tension Lock to the Bracket and test the operation of the Tension Lock

Make sure the Cord Tension Lock is not placed in the path of the bottom rail or fabric

P-Clip Safety Tensioner

Step 1 Install the Chain or Cord

Step 1

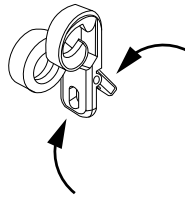

Squeeze the P clip together to close it

Step 2

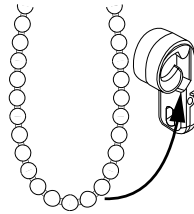

Slide Chain or Cord into the P-Clip

Step 3

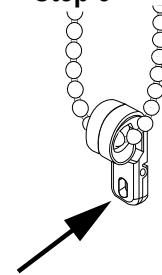

With the shade securely installed, pull the chain taut and mark the location on the mounting surface

Step 2 Install the Tensioner

The P-Clip Safety Tensioner can be installed in a few different orientations. Choose one that best suits your needs and make sure that the cord or chain is taut and moves freely through the Tensioner

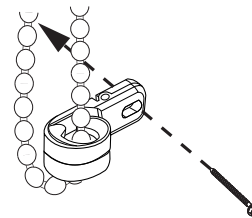
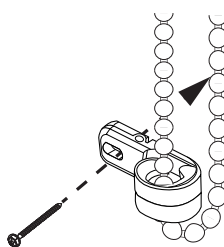
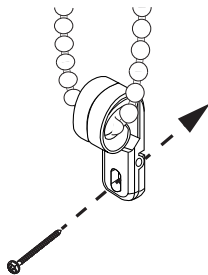

Then secure to the mounting surface using the screw provided

Make sure the P-Clip Safety Tensioner is not placed in the path of the bottom rail or fabric

It is imperative that the Tension Lock for bead chain or cord loops is properly secured to the wall or window frame to reduce a child's access to the chain or cord loops.

Young children and pets can wrap chains around their necks and strangle themselves.