

NEW STORE FRONTS, NEW PARKING, NEW PYLON NEW HARDSCAPE... SAME GREAT LOCATION!

Wetherington
Country Club



Tylersville Pointe Redevelopment

Tylersville Road & Cox Road, West Chester, OH 45069

- Located in Greater Cincinnati's West Chester Township which is the Economic Center of the Cincinnati-Dayton Metroplex with a Population of Over 3 Million
- West Chester is the Largest Township in the State of Ohio by Population and has been named to Money Magazine's list of Best Places to Live in America four consecutive times and five years overall (2017).
- West Chester is the Employment Epicenter in the Region with Over 6,000 Businesses and 90,000 Employees
- Conveniently Located off I-75 in West Chester, OH at Tylersville Road & Cox Road with Exposure to over 67,000 Vehicles Per Day

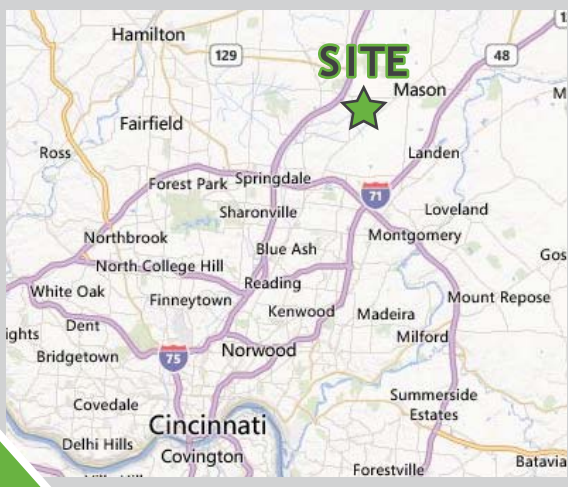

Demographics:
(3 & 5 mile radius/ 2018 Estimates)

Population	63,652
Average HH Income	\$131,036
Number of Households	23,219
Number of Employees	29,059
Population (2019 est.)	143,915
Average HH Income	\$131,180
Number of Households	53,132
Number of Employees	87,416



For additional information contact:
Nicole Chimento
nchimento@midlandatlantic.com
Phone.513.792.5000

www.midlandatlantic.com
@midlandatlantic

Cincinnati Office
8044 Montgomery Road, Suite 370, Cincinnati, OH 45236

Tylersville Pointe Development

Tylersville Road & Cox Road, West Chester, OH 45069

For additional information contact:

Nicole Chimento

nchimento@midlandatlantic.com

Phone.513.792.5000

LEASING PLAN - OPTION 1

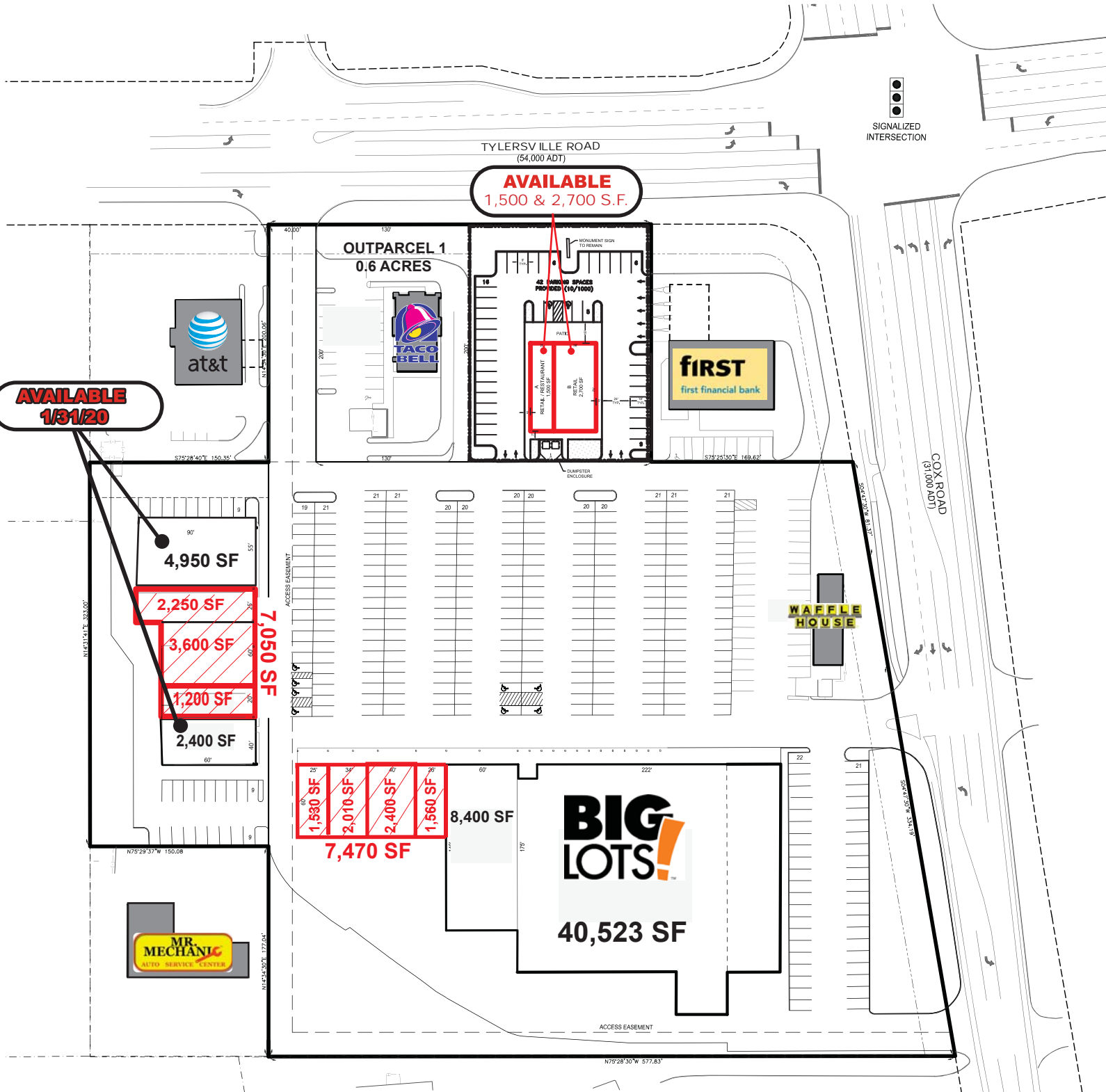

MIDLAND ATLANTIC
PROPERTIES

Tylersville Pointe Redevelopment

Tylersville Road & Cox Road, West Chester, OH 45069

For additional information contact:
Nicole Chimento
nchimento@midlandatlantic.com
Phone.513.792.5000

LEASING PLAN - OPTION 2

**ANCHOR, JR. ANCHOR, SMALL SHOP
SPACE & OUTPARCEL AVAILABLE**

